

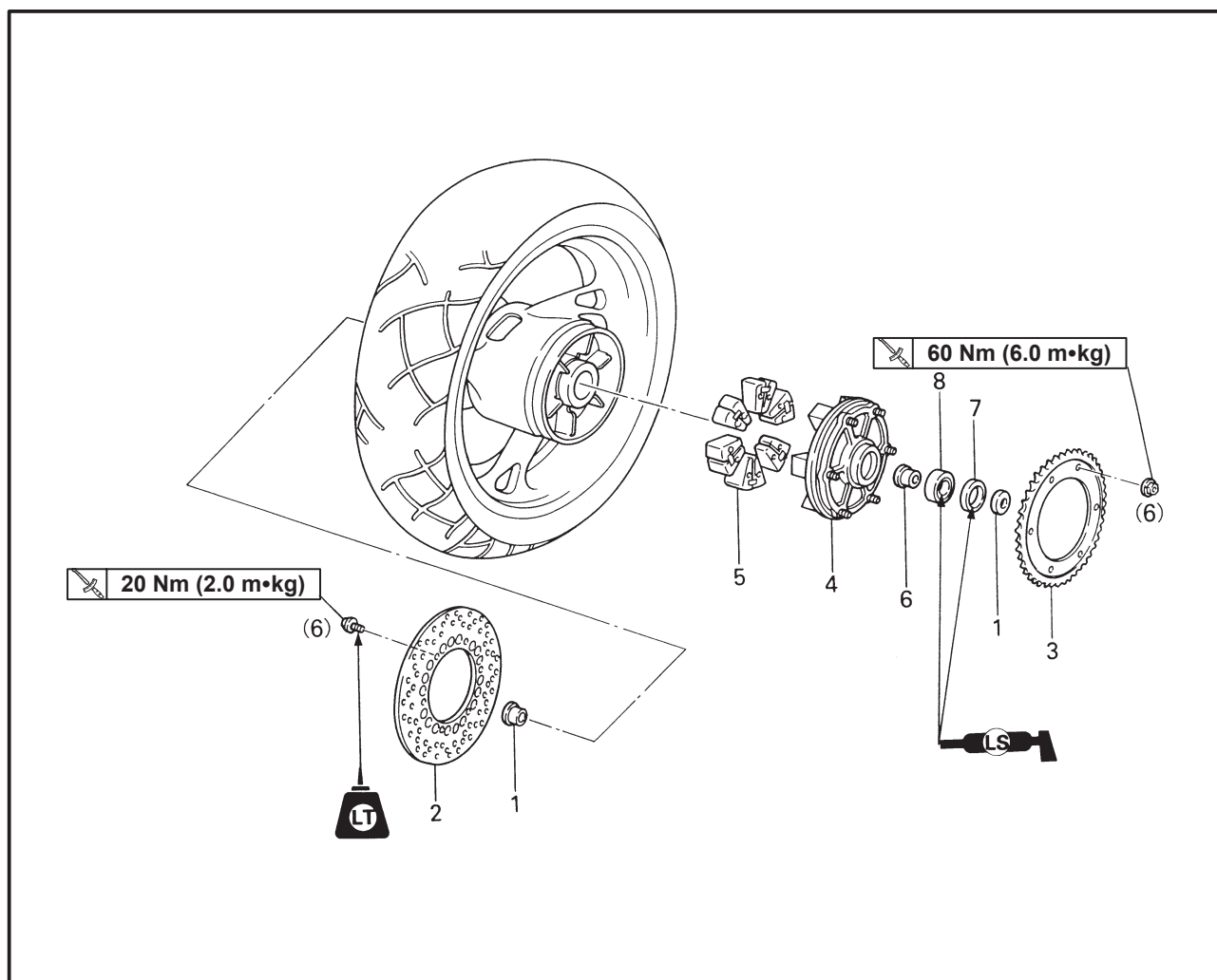

## BRAKE DISC AND DRIVEN SPROCKET



Order	Job name/Part name	Q'ty	Remarks
	<b>Brake disc and driven sprocket removal</b>		Remove the parts in the order below.
1	Collar (left/right)	1/1	
2	Brake disc	1	
3	Driven sprocket	1	
4	Clutch hub	1	
5	Rubber damper	6	
6	Collar	1	
7	Oil seal	1	
8	Bearing	1	
			For installation, reverse the removal procedure.